



Treka Mobility Van Operating Instructions
-
Mercedes Sprinter

Mercedes Sprinter

All 907 model Sprinter vehicles have the standard Radio/USB/iPod/Android Auto/Apple Car Play audio system. The USB point can be found on the dashboard. Additional leads are required to connect devices.

For more details on the use of the Mercedes systems please refer to the Mercedes Owner's Manual.

Checking AdBlue® Level

With the key in the vehicle and secure, start the engine the AdBlue Level will be displayed on the dash on the centre digital display.

The tank holds 14 Litres of AdBlue® enough for approx. 2700 Miles and once the level falls below 3.5 Litres an Amber warning light will show on the instrument cluster along with the message "TOP AdBlue® UP" you then have approx. 175 Miles to top up the tank before engine performance is restricted

Full details of this procedure and more on AdBlue® can be found inside you Mercedes Benz Sprinter Operating Instruction booklet.

Checking the Engine Oil Level

Engine oil levels can be checked from the multi-function steering wheel. Full details of this procedure and more on engine oil levels can be found inside you Mercedes Benz Sprinter Operating Instruction booklet.

Engine Bay Layout



1. Brake fluid expansion tank
2. Coolant expansion tank
3. AdBlue filler neck cap
4. Engine oil filler neck cap
5. Washer fluid reservoir cap
6. Auxiliary heater/AC/Climate antifreeze reservoir

The bonnet release handle is located to the nearside front of cab by the cab passenger door.

Vehicle Safety Features

The vehicle is fitted with a number of safety features:

- **Voiceover Information System** – this provides spoken safety and operational information and warning messages such as “caution rear doors open”.
- **Rear Parking Sensors** (if fitted) – these are activated when reverse gear is engaged and uses a variable pitch tone that increases, as the object behind the vehicle gets closer.
- **Front Parking Sensors** (if fitted) – these are active at all times except when either reverse gear or neutral is engaged and uses a variable pitch tone that increases as the object in front of the vehicle gets closer.
- **Side View Wing Camera** (if fitted) – when the relevant indicator is activated, the monitor provides a real time view along the side of the vehicle. The image fades once the indicator is turned off.
- **Reverse Camera** (if fitted) – when reverse gear is selected the monitor provides a real time view of the rear of the vehicle. The image fades once reverse gear has been deselected.

Side Step (if fitted)

The side step is operated either mechanically or electrically;

- **Mechanical operation** – the step will automatically deploy and stow as the side door is opened and closed.
- **Electrical operation** – the vehicle is fitted with two door operating switches, one on the drivers control panel (see attached diagram) and one on the side door ‘B’ pillar, either button can be used to deploy or stow the side step. If either switch is left in the ‘on’ position the side step will automatically deploy and stow as the side door is opened and closed. The side step must always be stowed fully before the vehicle is driven.

Internal lighting

All step well lighting and LED step edge lighting (if fitted) shall automatically illuminate when doors are open.

The roller ball lights located to the rear of the vehicle either side of the roof lining shall automatically illuminate the passenger lift area when the rear doors are open.

Fasten Seat Belts Sign

Fasten Seat Belts signs (if fitted) will operate in the following way:

1. When the vehicle detects the final door is closed the sign will illuminate for 60 seconds, after which it will automatically turn off.
2. The 60 second timer restarts each time the vehicle detects all doors are closed.
3. A rocker switch allows the driver to manually illuminate the sign constantly until turned off with the switch. This overrides the normal operation of the sign through door detection.

Heating/Air Conditioning/Climate Control

For details on the specific heating/air conditioning/climate control equipment installed on your vehicle please consult the equipment manufacturers literature.

Passenger Lift

For details on the specific passenger lift fitted to your vehicle please consult the equipment manufacturers literature.

Saloon Seats

To unlock the NMI Millennium fixture on a seat simply move the safety bar on the fixture into an upwards position and pull the red handle downwards to release from track. Then repeat on the other fixing.

To remove the seat or move them to either the front or rear of the vehicle, simply follow the above instructions. Once the seat is positioned in the desired location relock the NMI Millennium fixture.

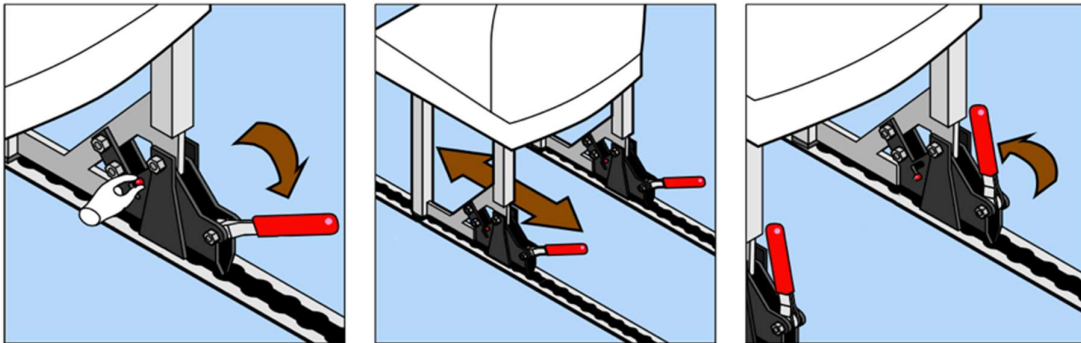

Seat Belt Wearing Instructions – Phoenix Seating

Please note the following, which applies to Phoenix seats with seat belt shoulder height adjustment:

Warning

- Never wear the diagonal webbing strap under the shoulder
- Never wear the diagonal webbing strap around the neck
- Never use a single seat belt for more than one (1) occupant
- When not in use ensure that the seat belt is not trapped in folding seats or doors
- Lap seat belts should fit snugly and as low as possible around the hips, NOT THE WAIST
- Front and rear seat occupants, including pregnant women, should wear seat belts for protection in a crash regardless of how short the journey is.

Using the Product

When using the lap and diagonal seat belt, extract the webbing strap and pull it diagonally across the body and engage the tongue into the buckle and press it home until you hear a positive 'click', this will confirm that the buckle latch has engaged with the tongue.

For occupants over 135cm (4'5") in height, the slider must be at the top of the seat. For smaller occupants whose shoulder is lower than the top of the seat when seated upright, the slider can be adjusted to a position below so that the belt rests across the middle of the shoulder.

The belt should only be pulled when the slider is in the upper most position – the slider can then be adjusted to suit the height of the occupant.



To release the seat belt press the red push button on the buckle and allow the tongue and webbing strap to disengage with the buckle.

Twisted Seat Belts

If one of the seat belts becomes twisted after use, there is a quick and easy way to untwist it without the use of any tools or taking the seat apart. To untwist your seat belt simply pull the seat belt out as far as it can, twist the seat belt at the top and feed the twist back through the escutcheon.

Watch a demonstration video of the untwisting of a seat belt on the website at:
www.phoenixseating.com/faqs-help

General Storage & User Information for Seats

All seating fitted to Treka Bus vehicles have been designed, developed and manufactured for the intended sole purpose of users to sit on and are fit for purpose. When removed from a vehicle store seats in an upright position in a dry environment and where possible cover seats to prevent any damage.

Warning: Never stack seats on top of one another or stack other products on top of the seats to save storage space. Never open any packaging or covering using a sharp object, such as a blade or knife.

Treka Mobility Van Driver's Control Panel

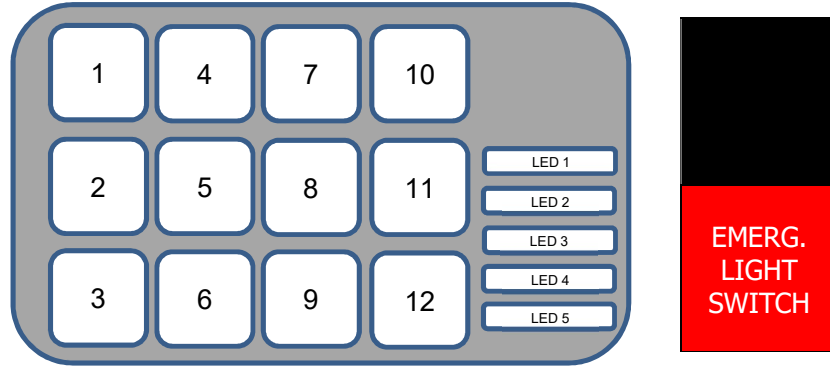

Key Assignments

Item No.	Description	Notes
1	-	Unassigned
2	-	Unassigned
3	-	Unassigned
4	-	Unassigned
5	Saloon Lights	First press: blue night lights Second press: white day lights Third press: lights off
6	Side Step Deployed warning*	Light will flash when the side step is deployed.
7	-	Unassigned
8	Seat Belt Sign Override	If pressed, override automatic function to turn sign on permanently.
9	Tail Lift Power	Press to turn on power for tail lift. Switch should only be turned on when tail lift is in use.
10	-	Unassigned
11	Reverse Alarm Silence	External reverse warning will sound automatically when reverse gear is engaged. Press to silence the warning (typically at night).
12	Tail Lift Deployed warning	Light will flash when the passenger lift is deployed.
LED 1	Driver's Door open warning	Light will flash when the driver's door is open
LED 2	Cab Passenger Door open warning	Light will flash when the cab passenger door is open
LED 3	Rear Door open warning	Light will flash when the rear doors are open
LED 4	Side Door open warning*	Light will flash when the nearside side sliding door is open.
LED 5	Heater Cut-Off warning	Light will flash when the external heater cut-off button is engaged.
	Emergency Light Switch	The emergency light switch is fitted in a dedicated switch next to the main driver's control panel. This circuit is permanently powered. If left on power drain will occur. Turning the switch to the 'on' position will turn on all exit lighting in the event of an emergency.

* These items only apply if relevant equipment is fitted

Unassigned switches are available for non-standard equipment or retrofit equipment.

Electrical System Reset

A system reset can often resolve minor electrical issue e.g. lights not operating correctly, incorrect warning messages. To reset the system press and hold the 'Saloon Lamp' button for ~5 seconds. You will know the system has reset when the keypad lights flash and the system emits a single beep.

Treka Mobility Van Operation Guide

Engine Cut Off

Engine cut off is on the ignition to the left hand side of the steering wheel.

Heater Shut Off Button

Located outside the vehicle to the left-hand side of the door below the fuel filler cap. When engaged this will cut off fuel from the vehicles auxiliary heater system. To reset press the switch again.

Note: if the switch is engaged the 'Heater Cut Off' warning light will illuminate on the drivers keypad

Passenger Lift Interlock

The passenger lift will only operate when the handbrake is engaged, tail lift isolator activated from drivers keypad, and the rear doors are open.

Step Well and Over-Door Lights

All step well and over-door lights will automatically illuminate when the corresponding door is opened

Heater Shutdown

The auxiliary heater will shutdown automatically when the ignition is switched off unless your vehicles was specified with a 30 or 60-minute run on timer.

Automatic Electrical Shutdown

The vehicle auxiliary electrical system will shutdown automatically 10 minutes after the ignition is turned off; if the "Tail Lift Isolator" switch is operated during this time the shutdown will extend to 30 minutes.

Note: emergency lights are permanently powered. If these are left turn on when the vehicle is not in use they will drain power.

Warning Messages

Your Treka Mobility minibus will provide spoken warning in English (additional languages can be added) for a range of events.

- "Please fasten seat belts" – when the handbrake is released.
- "Extreme caution, rear door open" – when either of the rear doors are open.
- "Extreme caution, side step deployed" – when the side step is deployed and the handbrake is released
- "Extreme caution, side door open" – when the side door is open and the handbrake is released
- "Extreme caution, tail lift deployed" – when the passenger lift is not fully stowed and the handbrake is released
- "Warning chassis battery low, start engine immediately" – when the chassis battery is running low
- "Warning auxiliary battery low, start engine immediately" – when the auxiliary battery is running low
- "Extreme caution, Fire Trace activated. Evacuate vehicle immediately" – when the Fire Trace fire-suppression system (if fitted) has been activated.