



Treka Everyday Operating Instructions

-

Renault Master

## **Renault Master**

The Renault Master has Radio/CD/USB/Aux and Bluetooth telephone connections. USB points can be found on the right-hand side of the radio controls, and the left-hand side of the driver's dashboard area. Additional leads are required to connect devices.

In addition to the above, all vehicles have Bluetooth telephony. To pair a phone with the vehicle:

1. Ensure that the desired phone has Bluetooth enabled and is set to 'Discoverable'
2. Press the 'TEL' button on the vehicle console
3. Select 'Bluetooth' and select 'On' and select 'Pair Device'
4. The vehicle will then search for all available phones. When the vehicle has completed its search select the desired phone
5. The vehicle will ask for confirmation that will also need to be confirmed using the phone.
6. When prompted on the phone select ok.
7. The vehicle will confirm once the pairing is complete
8. Select the Media button and then use your phone to play the desired sound.

Bonnet catch is located to the nearside front of cab under the dash

Driver's seat and seatbelt are fully adjustable.

### ***Checking AdBlue® Level***

1. Insert the key and turn to position 2 in the ignition.
2. On the display under the petrol gauge it will show the AdBlue gauge this will indicate the remaining amount of AdBlue®.

The tank holds 20 Litres of AdBlue® enough for approx. 3000 Miles the vehicle will advise you via messages on the dash when the AdBlue requires topping up,

Full details of this procedure and more on AdBlue® can be found inside your Renault Master Operating Instruction booklet.

### ***Checking the Engine Oil Level***

Only check the oil level when the engine is at normal operating temperature with the engine switched off.

1. Insert the key into the ignition and turn to position 2.
2. The display panel will show after 30 sec with the message "Oil Level Correct" (pictured below). If this message does not appear, check the oil using the dip stick.

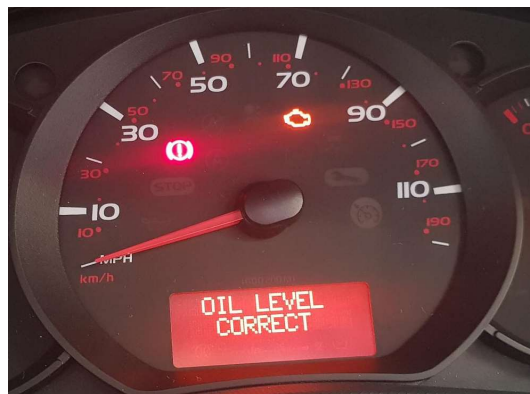

Full details of this procedure and more on engine oil levels can be found inside you Renault Master Operating Instruction booklet.

## Engine Bay Layout

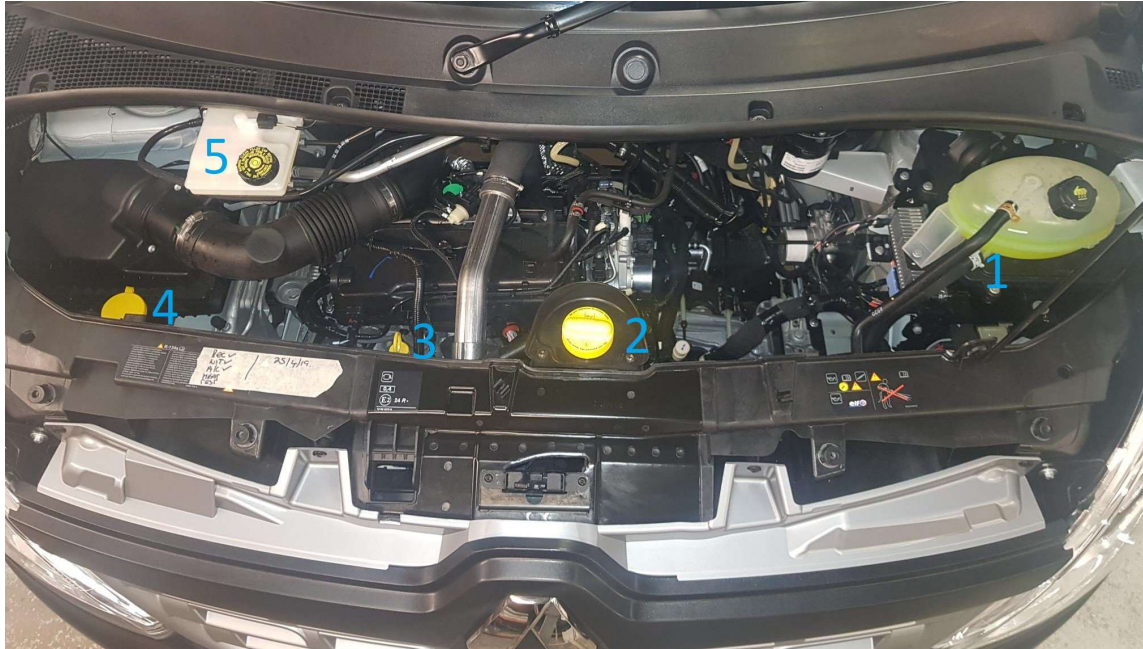

1. Coolant expansion tank
2. Engine oil filler neck cap
3. Oil Dip Stick
4. Washer fluid reservoir cap
5. Brake fluid expansion tank

### **DPF Regeneration**

The vehicle is equipped with a diesel particulate filter, the filter must be able to regenerate itself during the use of the vehicle. For this, the vehicle must be driven continuously in extra-urban areas for a minimum of 20 minutes at a minimum speed of 2000rpm; this should be undertaken every 124 miles travelled. This duration and speed allow automatic regeneration of the DPF.

## **Vehicle Safety Features**

The vehicle can be fitted with a number of safety features:

- **Rear Parking Sensors** (if fitted) – these are activated when reverse gear is engaged and uses a variable pitch tone that increases, as the object behind the vehicle gets closer.
- **Side View Camera** (if fitted) – when the left hand indicator or hazard lights are activated, the dashboard-mounted monitor provides a real time view along the nearside exterior of the vehicle. The image fades once the left hand indicator or hazard lights are turned off.
- **Reverse Camera** (if fitted) – when reverse gear is selected the monitor provides a real time view of the rear of the vehicle. The image fades once reverse gear has been deselected.

## **Side Step**

The side step is operated either mechanically or electrically;

- **Mechanical operation** – With the step stowed press your foot firmly on the release pedal on the right-hand side of the step, the step will then deploy. To stow the step, again press your foot firmly on the release pedal until it clicks, the you can push the step back into the cassette with your foot or hands.



- **Electrical operation** – the vehicle is fitted with an operating switch, on the side door 'B' pillar, the switch can be used to deploy or stow the side step.

## **Internal lighting**

All step well lighting shall automatically illuminate when doors are open. The lights located to the rear doors of the vehicle shall automatically illuminate the passenger lift area when the rear doors are open.

## **Driver's Keypad Panel**

The vehicle is fitted with a keypad that is within easy reach of the driver and contains all major control switches and buttons. See attached diagram for individual switch locations and functions.

## **User Guide**

See attached User Guide on that details the automatic features of the vehicle as well as the location and function of switches and buttons that are not part of the driver's keypad panel.

## **Heating/Air Conditioning/Climate Control**

For details on the specific heating/air conditioning/climate control equipment installed on your vehicle please consult the equipment manufacturers literature.

## **Passenger Lift**

For details on the specific passenger lift fitted to your vehicle please consult the equipment manufacturer's literature.

## **Saloon Seats**

To unlock the NMI Millennium fixture on a seat simply move the safety bar on the fixture into an upwards position and pull the red handle downwards to release from track. Then repeat on the other fixing.

To remove the seat or move them to either the front or rear of the vehicle, simply follow the above instructions. Once the seat is positioned in the desired location relock the NMI Millennium fixture.

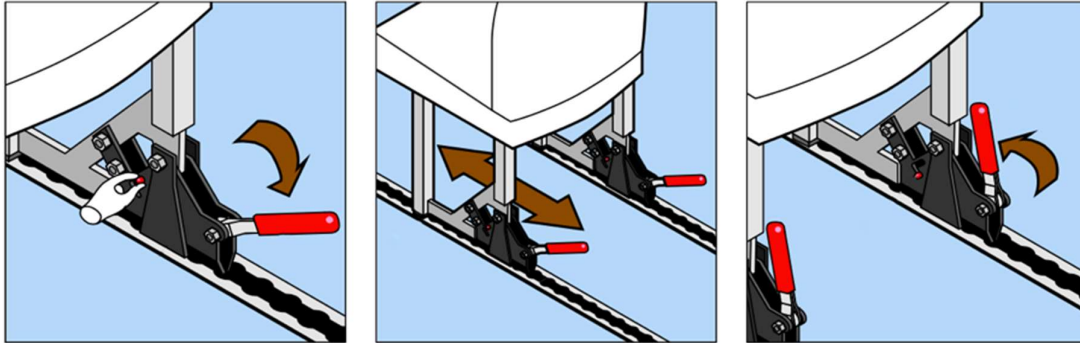

## **Seat Belt Wearing Instructions – Phoenix Seating**

Please note the following, which applies to Phoenix seats with seat belt shoulder height adjustment:

### ***Warning***

- Never wear the diagonal webbing strap under the shoulder
- Never wear the diagonal webbing strap around the neck
- Never use a single seat belt for more than one (1) occupant
- When not in use ensure that the seat belt is not trapped in folding seats or doors
- Lap seat belts should fit snugly and as low as possible around the hips, NOT THE WAIST
- Front and rear seat occupants, including pregnant women, should wear seat belts for protection in a crash regardless of how short the journey is.

### ***Using the Product***

When using the lap and diagonal seat belt, extract the webbing strap and pull it diagonally across the body and engage the tongue into the buckle and press it home until you hear a positive 'click', this will confirm that the buckle latch has engaged with the tongue.

For occupants over 135cm (4'5") in height, the slider must be at the top of the seat. For smaller occupants whose shoulder is lower than the top of the seat when seated upright, the slider can be adjusted to a position below so that the belt rests across the middle of the shoulder.

The belt should only be pulled when the slider is in the upper most position – the slider can then be adjusted to suit the height of the occupant.



To release the seat belt press the red push button on the buckle and allow the tongue and webbing strap to disengage with the buckle.

### ***Twisted Seat Belts***

If one of the seat belts becomes twisted after use, there is a quick and easy way to untwist it without the use of any tools or taking the seat apart. To untwist your seat belt simply pull the seat belt out as far as it can, twist the seat belt at the top and feed the twist back through the escutcheon.

Watch a demonstration video of the untwisting of a seat belt on the website at:  
[www.phoenixseating.com/faqs-help](http://www.phoenixseating.com/faqs-help)

### ***General Storage & User Information for Seats***

All seating fitted to Treka Bus vehicles have been designed, developed and manufactured for the intended sole purpose of users to sit on and are fit for purpose. When removed from a vehicle store seats in an upright position in a dry environment and where possible cover seats to prevent any damage.

**Warning:** Never stack seats on top of one another or stack other products on top of the seats to save storage space. Never open any packaging or covering using a sharp object, such as a blade or knife.

## Treka Everyday Drivers Keypad

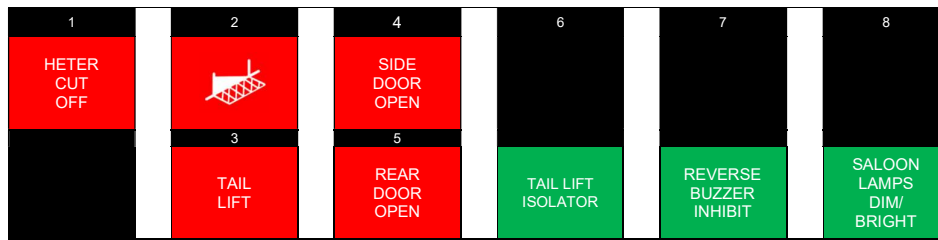

1. Light will illuminate when the exterior heater cut off button is engaged preventing the heater from operating.
2. Light will flash when the side step (if fitted) is deployed.
3. Light will flash when the passenger lift is deployed.
4. Light will flash when the nearside side sliding door (main passenger entrance) is open.
5. Light will flash when the rear doors are open.
6. Switch to the on position to provide power to the passenger lift.
7. External reverse warning will sound automatically when reverse gear is engaged. Switch to the on position to silence the warning (typically at night).
8. Press once to turn on blue night lights. Press again to turn on white day lights. Reset to off position to turn off lights.

### Advisory Note for Tail Lift Isolator Switch

The 'Tail Lift Isolator' switch should always be turned off when the lift is not in use.

# Treka Everyday Operation Guide

## Functions

### Passenger Lift Interlock

The passenger lift will only operate when the handbrake is full engaged, tail lift isolator activated from driver's keypad, and the rear doors are open.

### Step Well and Over-Door Lights

All step well and over-door lights will automatically illuminate when the corresponding door is opened.

### Heater Shutdown

The auxiliary heater will shut down automatically when the ignition is turned off unless your vehicles was specified with a 30 or 60-minute run on timer.

### Battery Guard

The vehicle is fitted with a battery guard system to ensure that the vehicle battery is protected from being drained. The battery guard system will cut off auxiliary electrical system (e.g. saloon lights) if the battery drains to a point where starting power is at risk. In order to reset the battery guard system simply press the button locate in the centre console of the vehicle.

